

SPINNING REEL — SF2650

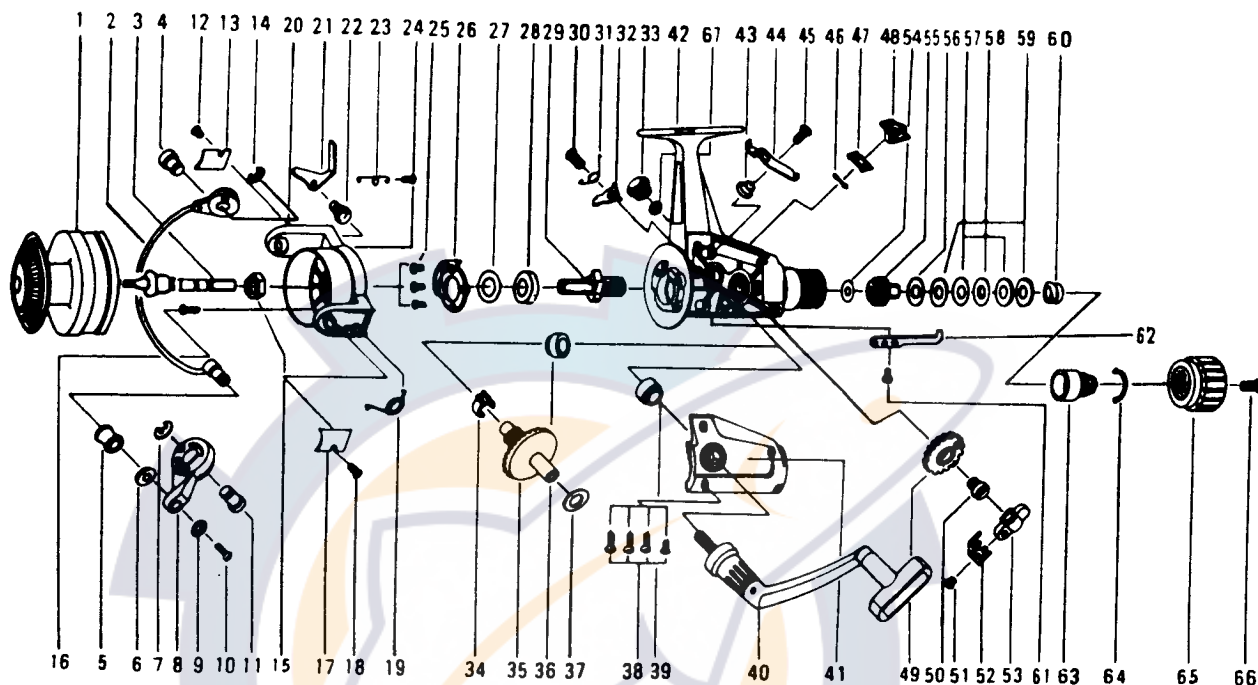

| Key No. | Part No. | Part Name | Price | Key No. | Part No. | Part Name | Price |
|---------|----------|------------------------------|-------|---------|----------|---------------------------------|-------|
| 1 | SF2-0010 | Spool assembly | 7.00 | 35 | SF2-0350 | Drive gear | 3.50 |
| 2 | SF2-0020 | Bail assembly | 5.00 | 36 | SF2-0360 | Bushing | 2.50 |
| 3 | SF2-0030 | Main shaft assembly | 2.50 | 37 | SF2-0370 | Driver gear adjusting washer | .40 |
| 4 | SF2-0040 | Bail trip cam screw | .60 | 38 | SF2-0380 | Side cover screw | .50 |
| 5 | SF2-0050 | Line roller | 1.90 | 39 | SF2-0360 | Bushing | 2.50 |
| 6 | SF2-0060 | Line roller washer | .45 | 40 | SF2-0400 | Handle assembly | 8.50 |
| 7 | SF2-0070 | Bail arm screw retainer | .45 | 41 | SF2-0410 | Side cover | 3.85 |
| 8 | SF2-0080 | Bail arm | 1.00 | 42 | SF2-0420 | Body | 9.50 |
| 9 | SF2-0090 | Line roller lock washer | .45 | 43 | SF2-0430 | Anti-reverse cam bushing | .80 |
| 10 | SF2-0100 | Line roller screw | .50 | 44 | SF2-0440 | Anti-reverse cam | 1.00 |
| 11 | SF2-0110 | Bail arm screw | 1.00 | 45 | SF2-0450 | Anti-reverse cam screw | .60 |
| 12 | SF1-0110 | Bail trip cover screw | .45 | 46 | SF2-0460 | Anti-reverse lever pin | .50 |
| 13 | SF2-0130 | Bail trip cover | .70 | 47 | SF2-0470 | Anti-reverse lever plate spring | .50 |
| 14 | SF2-0070 | Bail trip cam screw retainer | .45 | 48 | SF2-0480 | Anti-reverse lever | .50 |
| 15 | SF2-0150 | Rotor nut | .55 | 49 | SF2-0490 | Oscillating gear | 2.00 |
| 16 | SF2-0160 | Rotor nut lock screw | .50 | 50 | SF2-0500 | Oscillating gear screw | .70 |
| 17 | SF2-0170 | Bail spring cover | .70 | 51 | SF2-0510 | Oscillating slider screw | .50 |
| 18 | SF1-0170 | Bail spring cover screw | .45 | 52 | SF2-0520 | Oscillating slider holder plate | .85 |
| 19 | SF2-0190 | Bail spring | .60 | 53 | SF2-0530 | Oscillating slider | 2.00 |
| 20 | SF2-0200 | Rotor | 5.70 | 54 | SF2-0540 | Drag "E" washer | .60 |
| 21 | SF2-0210 | Bail trip lever | 1.00 | 55 | SF2-0550 | Click gear | 2.30 |
| 22 | SF2-0220 | Bail trip screw | .45 | 56 | SF2-0560 | Drag "C" washer | .60 |
| 23 | SF2-0230 | Bail trip spring | .60 | 57 | SF2-0570 | Drag "B" washer | .60 |
| 24 | SF2-0240 | Bail trip spring screw | .55 | 58 | SF2-0580 | Drag "D" washer | .60 |
| 25 | SF1-0180 | Bearing plate screw | .45 | 59 | SF2-0590 | Drag "A" washer | .60 |
| 26 | SF2-0260 | Bearing plate | 1.25 | 60 | SF2-0600 | Drag coil spring | 1.25 |
| 27 | SF2-0270 | Bearing washer | .45 | 61 | SF2-0610 | Click claw screw | .50 |
| 28 | SF2-0280 | Pinion bushing | 2.50 | 62 | SF2-0620 | Click claw spring | .70 |
| 29 | SF2-0290 | Pinion gear | 3.50 | 63 | SF2-0630 | Drag screw | .70 |
| 30 | SF2-0300 | Anti-reverse claw screw | .60 | 64 | SF2-0640 | Drag washer spring | .60 |
| 31 | SF2-0310 | Anti-reverse claw spring | .60 | 65 | SF2-0650 | Drag knob | 2.50 |
| 32 | SF2-0320 | Anti-reverse claw | .55 | 66 | SF2-0660 | Drag knob screw | .60 |
| 33 | SF2-0330 | Handle lock screw | .60 | 67 | SF1-0540 | Handle lock washer | .45 |
| 34 | SF2-0340 | Slider spring | .70 | | | | |